

# Toward a world-class center for research and personnel development

## Creating a center of excellence for research and personnel development around the Next-Generation Supercomputer

In cooperation with research institutions and universities, RIKEN aims to establish a center of excellence for research and personnel development around the Next-Generation Supercomputer

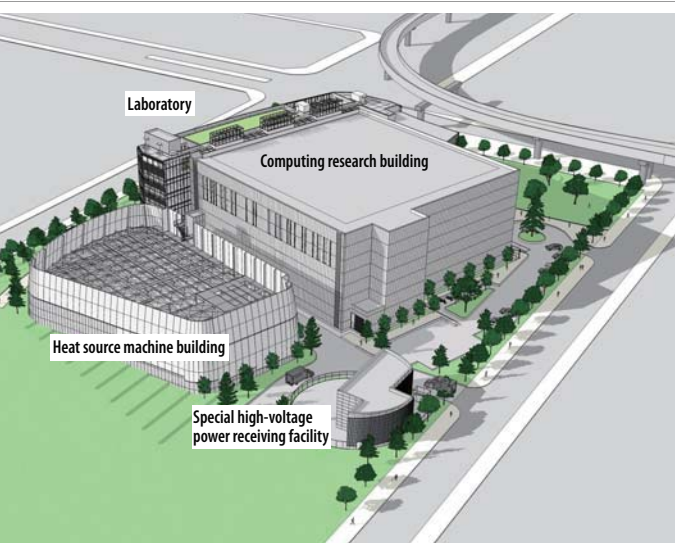
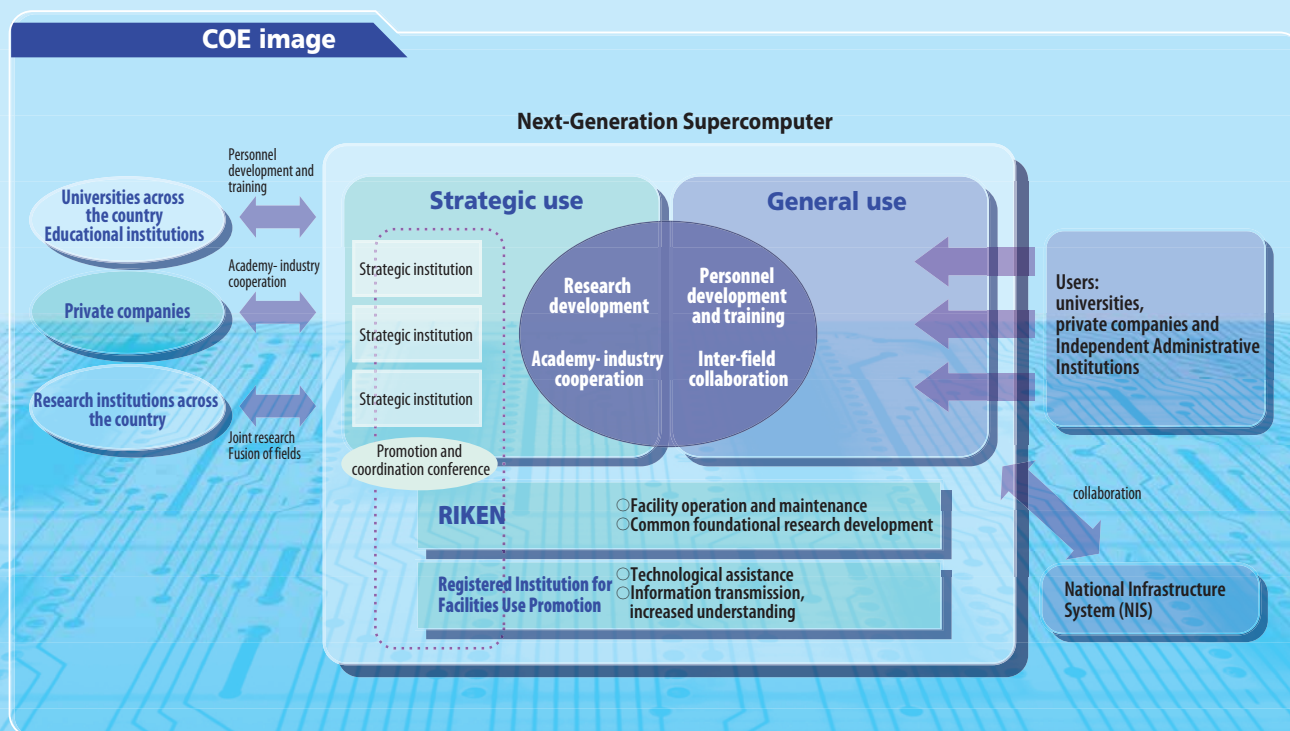

### The site of the supercomputer

The supercomputer center is being built in the city of Kobe, within the 2nd stage area of Port Island.  
 Access: The site is a one-minute walk from Port Island Minami station, which is 25 minutes by train from Shin-Kobe station or 10 minutes from Kobe airport. From Narita airport (Tokyo), first take the JR Narita Express to Tokyo station, then take the Shinkansen (bullet train) for three hours to Shin-Kobe.  
 Address: 7 Minatojima-minamimachi, Chuo-ku, Kobe, Hyogo, 650-0047, Japan